

Materials

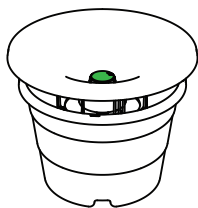

In2Care Station



Zip Tie
spec:
width: 4.8mm
length: min. 200mm

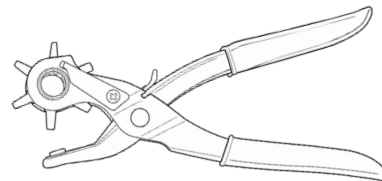

Punch Pliers

Instructions

Link:

[Video of Lid Fastening](#)

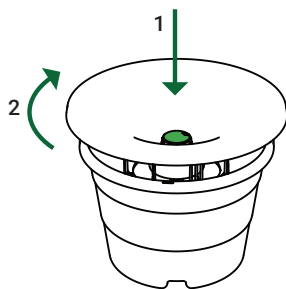

Place the lid on the central tube, push it down and turn it clockwise.

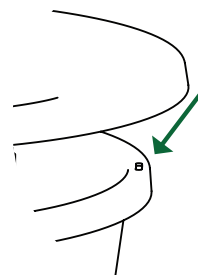

Locate the holes in the rim of the pot for fixation with a Zip Tie.



Rotate the Punch Pliers head to select the largest punch size.

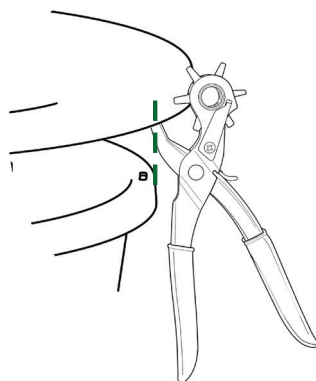

Place the Punch Pliers on the side of the Lid and make sure the Punch Pliers is aligned with the holes in the pot.

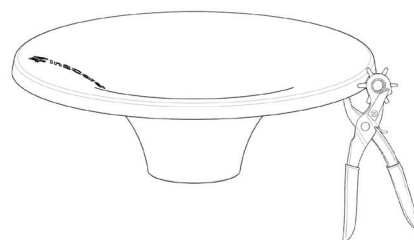

Punch a hole in the Lid, Repeat previous two (2) steps for the other side of the Lid.

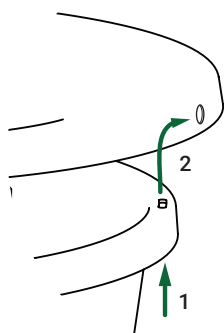

Use the Zip Tie to connect the two aligned holes.

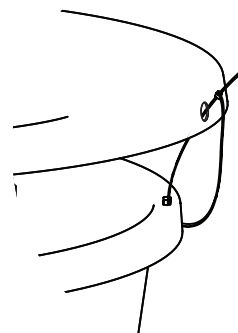

Tighten the Zip Tie sufficiently, so that removing the Lid is not possible.

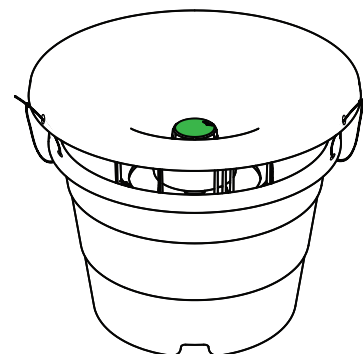

Repeat previous two (2) steps to fasten the other side of the Lid.



Note:

For station servicing and removing of the Lid, Zip Ties need to be cut off. After servicing is complete Zip Ties can be re-applied.